

Type: **DILET70-A**  
 Article No.: **048893**  
 Sales text **TIMING RELAY DILET**



Ordering information			
Description			Multi-function relay with connection for remote potentiometer
Rated operational current AC-11			
220 V 230 V 240 V	$I_e$	A	3
380 V 400 V 440 V	$I_e$	A	3
Conventional thermal current	$I_{th}$	A	6
Time range			0.15 – 3 s 0.5 – 10 s 3 – 60 s 0,15 – 3 min 0.5 – 10 min 3 – 60 min 0.15 – 3 h 0.5 – 10 h 3 – 60 h
Function			Adjustable 11, On-delayed 21, Fleeting contact on energization 42, Flashing 81, Pulse generating ON-OFF
Function			Adjustable 12, Off-delayed 16, On- and Off-delayed 22, Fleeting contact on de-energization 82, Pulse shaping ON-OFF

12, Off-delayed  
 16, On- and Off-delayed  
 22, Fleeting contact on de-energization  
 82, Pulse shaping  
 ON-OFF

### Terminal marking according to EN 50042

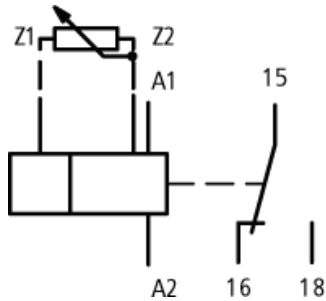

### Terminal marking according to EN 50042

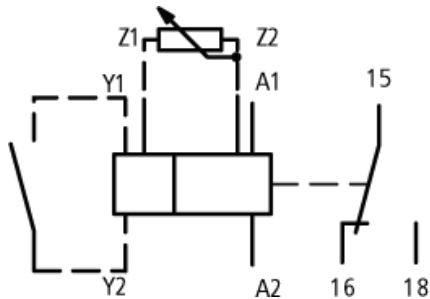

### Notes concerning the product group

Part no. suffix	Actuating voltage	
	V DC	V AC
-A	24 – 240	24 – 240, 50/60 Hz
-W	–	400, 50/60 Hz

Permissible cable length Connection to  
 Cable unscreened, with  
 cable cross-section 0.5 Y1/Y2, Z1/Z2  
 – 1.5 mm

Two-core cable 250 m

Two-core cable in the  
 same cable duct with 50 m  
 mains cable, 50/60 Hz

Accessories	Page
Time functions	→ Engineering
Sealable shroud	→ <u>010482</u>
Potentiometer	→ <u>229491</u>

Screw adapter → [095853](#)

Blade terminals → [059904](#)

<b>General</b>			
Standards			IEC/EN 60947, VDE 0660, UL, CSA IEC/EN 60255, VDE 0435
Lifespan, mechanical			
AC operated	Operations	$\times 10^6$	30
DC operated	Operations	$\times 10^6$	30
Climatic proofing			Damp heat, constant, to IEC 60068-2-78; Damp heat, cyclic, to IEC 60068-2-30
Ambient temperature			
Open		°C	-20...60
Enclosed		°C	-20...45
Mounting position			As required
Mechanical shock resistance (IEC/EN 60068-2-27)			
Half-sinusoidal shock, 20 ms			
Make contact		g	4
Degree of protection			
Terminals			IP 20
Weight		kg	0,09
Terminal capacities			
Solid		mm <sup>2</sup>	1 × (0.75 – 2.5) 2 × (0.75 – 2.5)
Flexible with ferrule		mm <sup>2</sup>	1 × (0.75 – 1.5) 2 × (0.75 – 1.5)
Solid or stranded		AWG	1 × (18 – 14)
<b>Contacts</b>			
Rated impulse withstand voltage	$U_{imp}$	V AC	6000
Overtoltage category/pollution degree			III/2
Rated insulation voltage	$U_i$	V AC	600
Rated operational voltage	$U_e$	V AC	440
Safe isolation to VDE 0106 Part 101 and Part 101/A1			
between coil and auxiliary contacts		V AC	250
between the auxiliary contacts		V AC	250

Making capacity			
AC-14 $\cos = 0.3$ 440 V		A	48
AC-15 $\cos = 0.3$ 220 V		A	50
DC-11 L/R – 40 ms		$\times I_e$	1,1
Breaking capacity			
AC-14 $\cos = 0.3$ 440 V		A	3
AC-15 $\cos = 0.3$ 220 V		A	3
DC-11 L/R – 40 ms		$\times I_e$	1,1
Rated operational current			
AC—14			
440 V	$I_e$	A	3
AC-15			
220 V	$I_e$	A	3
DC-11			
L/R max. 15 ms			
24 V	$I_e$	A	1,5
L/R max. 50 ms			
Conv. thermal current	$I_{th}$	A	6
Short-circuit rating without welding			
Max. fuse, make contacts		A gG/gL	6
Max. fuse, break contacts		A gG/gL	6
<b>Magnet systems</b>			
Power consumption			
Pick-up AC		VA	2
Sealing AC		VA	2
Pick-up DC		W	1,8
Sealing DC		W	1,8
Duty factor		% DF	100
Maximum operating frequency		Ops/h	4000
Minimum command time			
AC		ms	50
DC		ms	30
Repetition accuracy (deviation)		%	0,5
Recovery time (after 100% time delay)		ms	70
<b>Notes</b>			
<b>Notes</b>			Making and breaking

conditions to DC-13, time constant as stated  
When supplied directly from mains or transformer > 1000 VA  
Not DILET...-W  
ETR4-51: 50 ms

### Dimensions

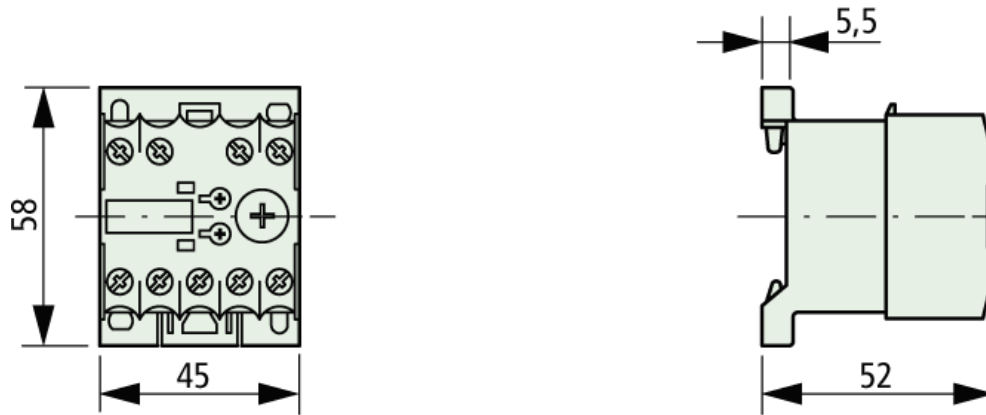

DILET...

### Dimensions

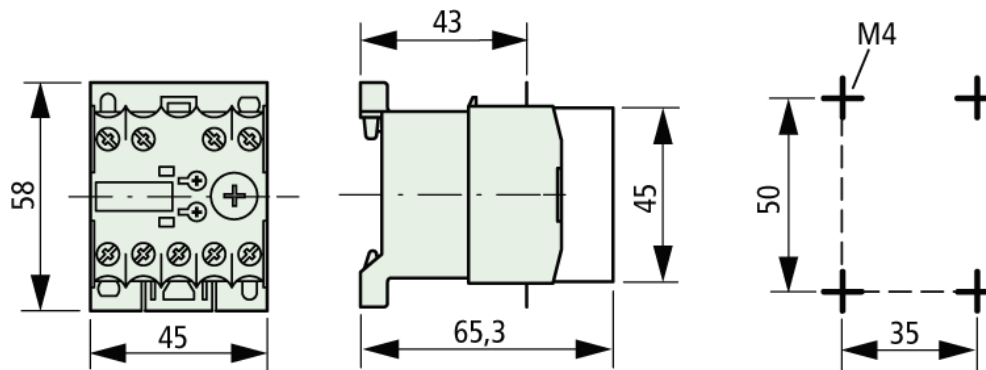

DILET... + HDILE  
Electronic timing relay with sealable shroud

### Characteristic curve

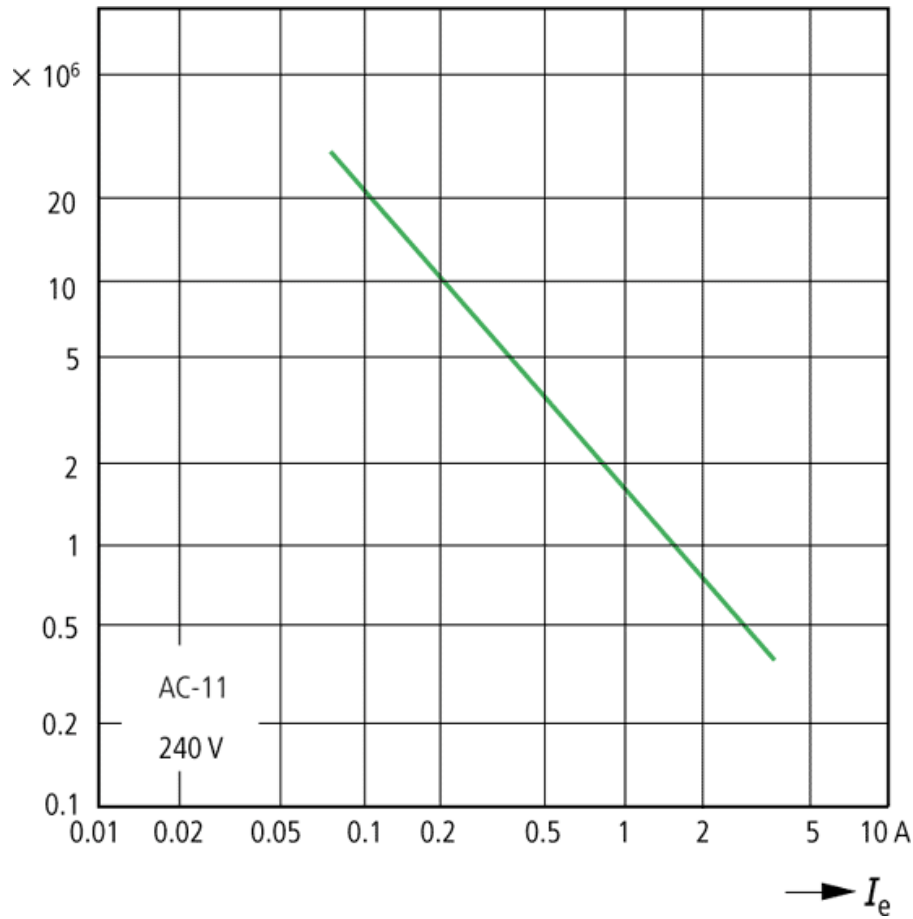

---

Component lifespan (operations)  
 $I_e$  = Rated operational current

---

Moeller GmbH, Hein-Moeller-Str. 7-11, D-53115 Bonn  
 E-Mail: [catalog@moeller.net](mailto:catalog@moeller.net), Internet: [www.moeller.net](http://www.moeller.net), <http://catalog.moeller.net>  
 HPL-C2007G V2.1 © 2007 by Moeller GmbH