

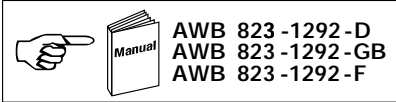

DE 4-NET-K

06/97 AWA 823-1572



AWB 823 -1292 -D
 AWB 823 -1292 -GB
 AWB 823 -1292 -F



(D)

Lebensgefahr durch elektrischen Strom!
 Nur Elektrofachkräfte und elektrotechnisch unterwiesene Personen dürfen die im folgenden beschriebenen Arbeiten ausführen.

(GB)

Electric current! Danger to life!
 Only skilled or instructed persons may carry out the following operations

(F)

Tension électrique dangereuse!
 Seuls les personnes qualifiées et averties doivent exécuter les travaux ci-après.

(I)

Pericolo di morte causa corrente elettrica!

Solo persone istruite e avvertite possono eseguire le operazioni di seguito riportate.

(E)

Corriente eléctrica! Peligro de muerte!
 El trabajo a continuación descrito debe ser realizado por personas cualificadas y advertidas.

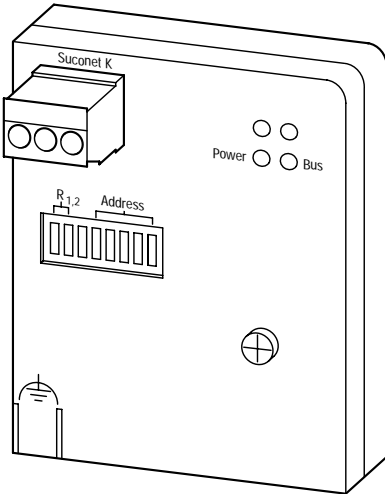

Abmessungen

Dimensions

Dimensioni



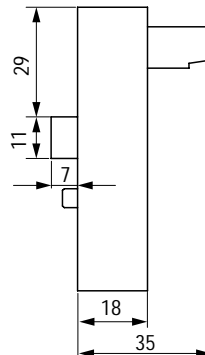
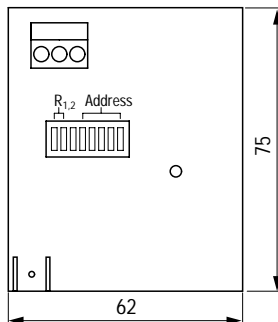

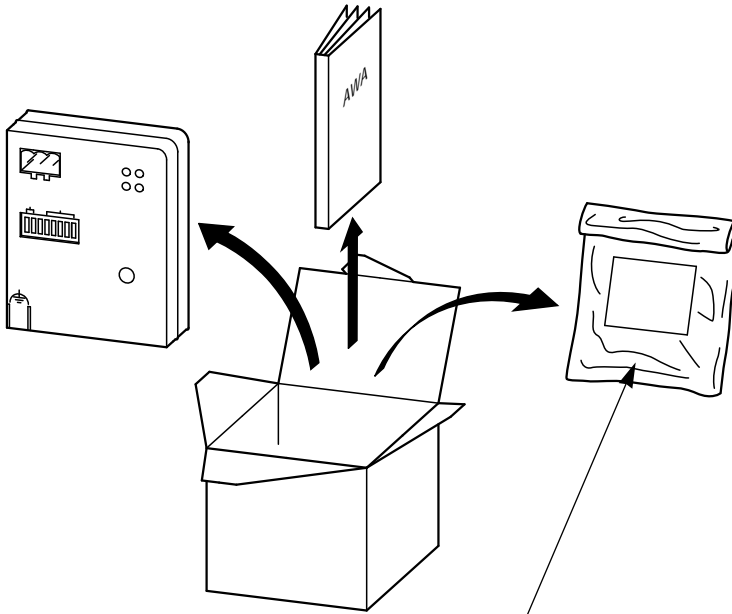
Dimensiones



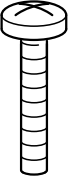
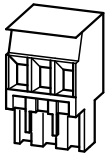
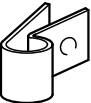
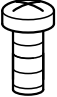

Beipack
 Assembly kit
 Kit de montage
 Kit de montaje

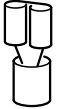
06/97 AWA 823-1572

						
1	1	2	2	2	2	1
M3 x 30Z1 DIN 7985			M4 x 8 ISO 7045	DIN 125 -A4.3	6,3 - 2,5 DIN 46245	4 - 2,5 DIN 46237

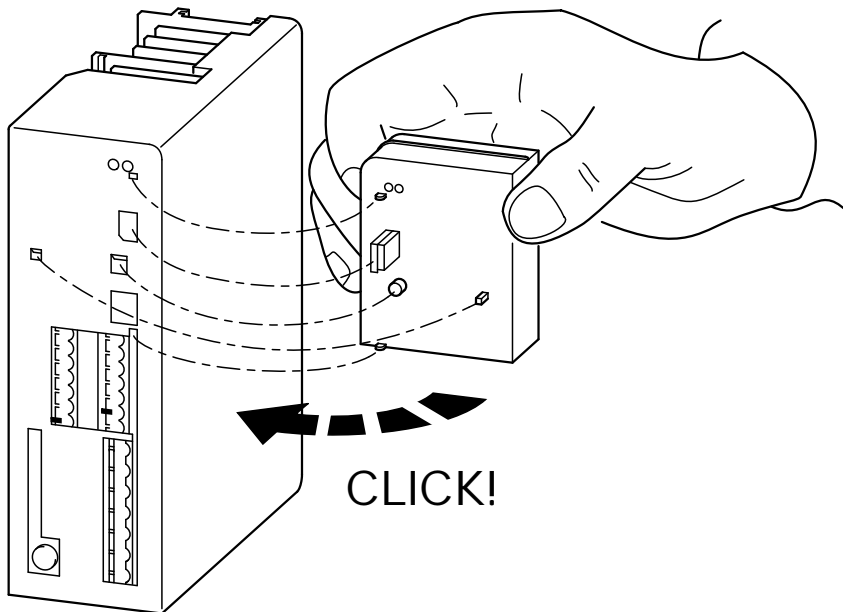

06/97 AWA 823-1572

- Ⓓ Busschnittstelle DE 4-NET-K für die Frequenzumrichterreihe DF 4-34x.
DE 4-NET-K ohne Gewaltanwendung aufstecken oder abziehen.
- ⒼⒹ DE 4-NET-K bus interface for the DF 4-34x frequency inverters.
Do not fit or remove the DE 4-NET-K by force.
- Ⓕ Liaison bus DE 4-NET-K des convertisseurs de fréquence de la série DF 4-34x
Retirer ou brancher sans forcer.
- Ⓘ Interfaccia di bus DE 4-NET-K per i convertitori di frequenza della serie DF 4-34x.
Staccare e connettere la DE 4-NET-K senza fare forza.
- Ⓔ Interface del bus de DE 4-NET-K de la serie de convertidores de frecuencia DF 4-34x.
No fuerce el montaje o desmontaje de la DE 4-NET-K.

Anschlüsse

Connections

Raccordements

Collegamenti

Conexiones

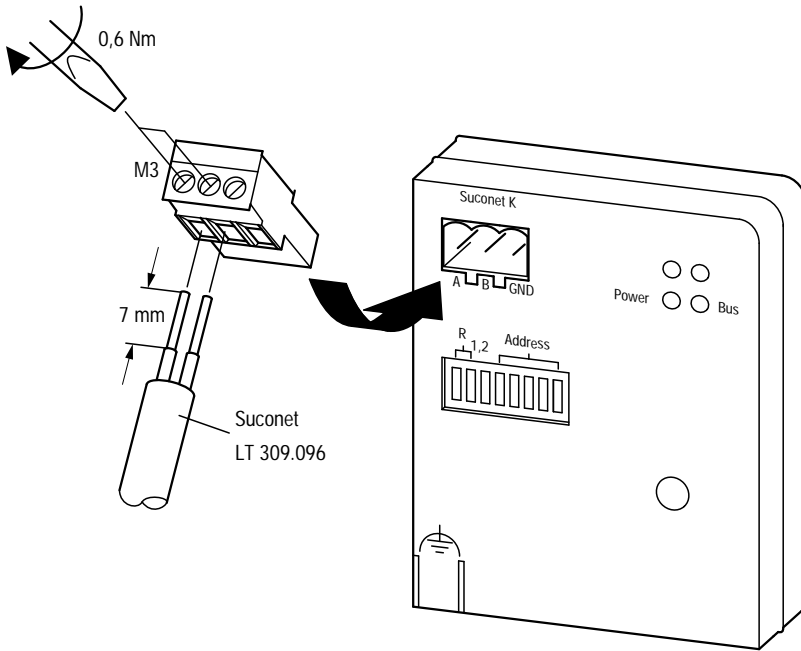

A	TA/RA
B	TB/RB
GND	100 Ω GND

06/97 AWA 823-1572

Schirmkabel
 Screen cable
 Câble de blindage
 Cavo de schermo
 Cable de blindaje

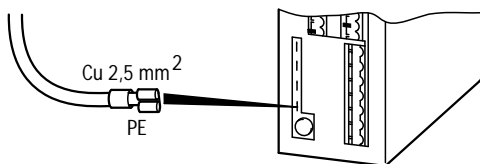
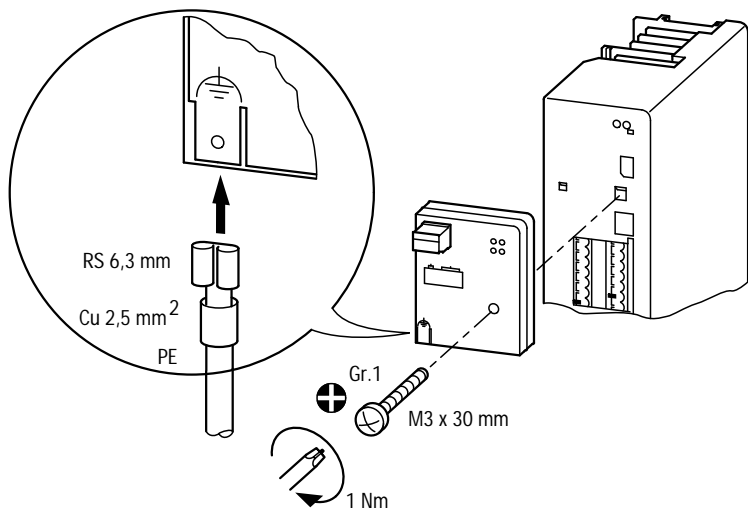

DF 4-340-075
 DF 4-340-1K5
 DF 4-340-2K2
 DF 4-340-3K0

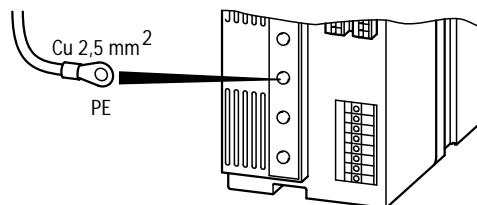

DF 4-340-4K0
 DF 4-340-5K5
 DF 4-340-7K5
 DF 4-340-11K

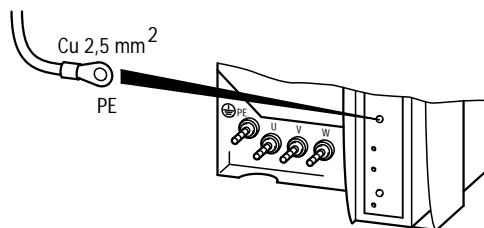

DF 4-341

06/97 AWA 823-1572

Schalterstellung im
Auslieferungszustand
Factory setting
Position à la livraison
Impostazione di fabbrica
Posición de entrega

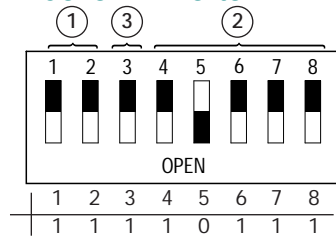

0 = aus / open / ouvert / aperto / abierto
1 = ein / close / fermé / chiuso / cerrado

③
Keine Funktion
No function
Non affecté
Senza funzione
Sin función

①
Busabschluß-
widerstände
Bus terminating
resistors
Résistance de
terminaison de bus
Bus resistenci di
terminazione
Bus resistencias
terminales

①	1. Gerät 1. Device 1. Appareil 1. Apparecchio 1. Aparato	2.	letztes Gerät last device dernier appareil ultimo apparecchio último aparato
1	1	0	0	1
2	1	0	0	1

0 = aus / open / ouvert / aperto / abierto
1 = ein / close / fermé / chiuso / cerrado

②
Codierung
Coding
Codage
Codifica
Codificación



- Ⓓ Adreßcodierung nur bei ausgeschalteter Stromversorgung erlaubt!
- ⒼⒸ Always switch off the power supply when setting the address coding!
- Ⓕ Coupez toujours l'alimentation courant avant de procéder au codage des adresses!
- Ⓘ La codifica degli indirizzi è possibile solo se l'alimentazione è spenta!
- Ⓔ ¡Codificar las direcciones sólo con la alimentación desconectada!

②	1	2	3	4	5	6	7	8	9	10	11	12	13	14	15	16	17	18	19	20	21	22	23	24	25	26	27	28	29	30
1	①																													
2	①																													
3	-	-	-	-	-	-	-	-	-	-	-	-	-	-	-	-	-	-	-	-	-	-	-	-	-	-	-	-	-	
4	1	0	1	0	1	0	1	0	1	0	1	0	1	0	1	0	1	0	1	0	1	0	1	0	1	0	1	0	1	0
5	0	0	1	1	0	0	1	1	0	0	1	1	0	0	1	1	0	0	1	1	0	0	1	1	0	0	1	1	0	0
6	1	1	0	0	0	0	1	1	1	1	0	0	0	0	1	1	1	1	0	0	0	0	1	1	1	0	0	0	0	0
7	1	1	1	1	1	1	0	0	0	0	0	0	0	0	1	1	1	1	1	1	1	1	0	0	0	0	0	0	0	0
8	1	1	1	1	1	1	1	1	1	1	1	1	1	0	0	0	0	0	0	0	0	0	0	0	0	0	0	0	0	0

0 = aus / open / ouvert / aperto / abierto
1 = ein / close / fermé / chiuso / cerrado

Schirmung auf Montageplatte

Screen on mounting plate

Blindage sur plaque de montage

Schermatura su piastra di monaggio

Blindaje sobre placa

06/97 AWA 823-1572

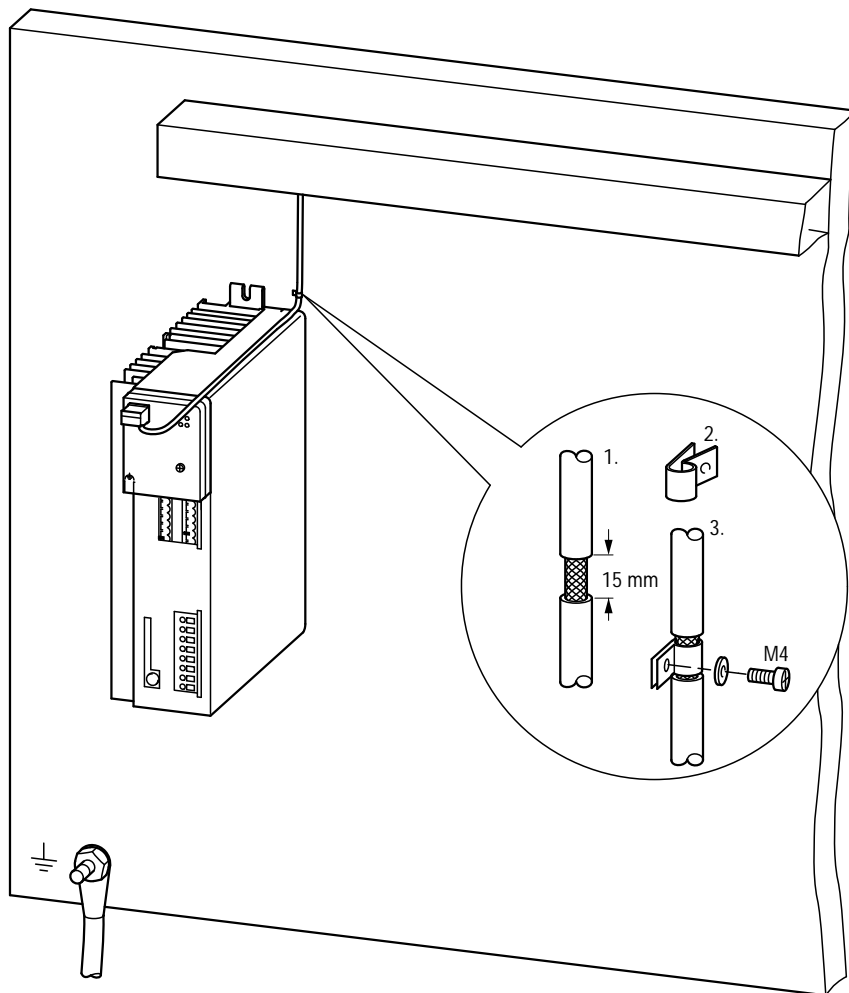

DF 4-340-075

DF 4-340-1K5

DF 4-340-2K2

DF 4-340-3K0

Schirmung auf Frequenzumrichter

Screen on frequency inverter

Blindage sur convertisseur de fréquence

Schermatura su convertitore di frequenza

Blindaje sobre convertidor de frecuencia

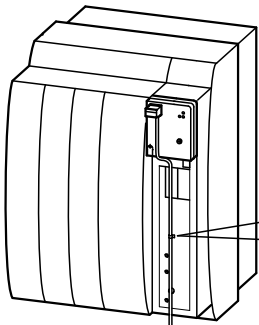

- DF 4-340-4K0
- DF 4-340-5K5
- DF 4-340-7K5
- DF 4-340-11K
- DF 4-341

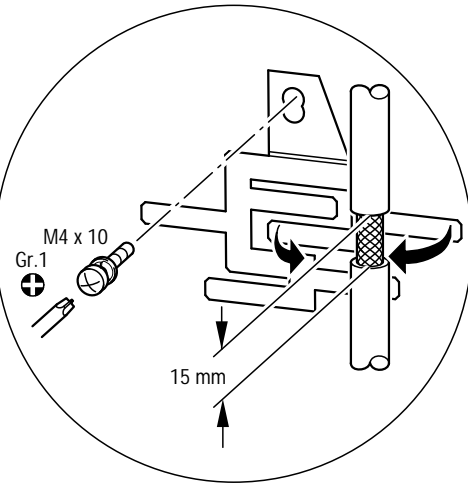

Schirmung auf Montageplatte

Screen on mounting plate

Blindage sur plaque de montage

Schermatura su piastra di montaggio

Blindaje sobre placa

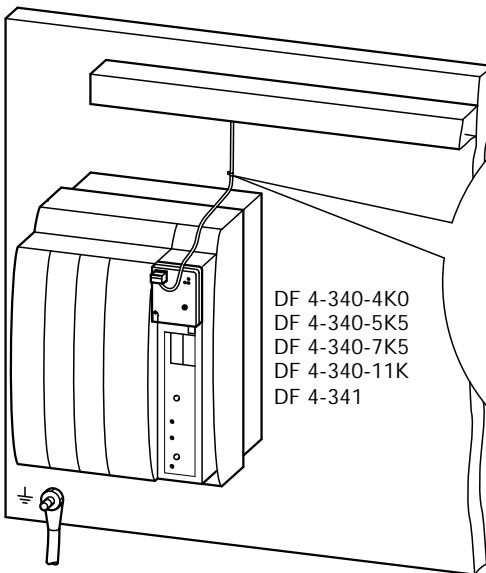

- DF 4-340-4K0
- DF 4-340-5K5
- DF 4-340-7K5
- DF 4-340-11K
- DF 4-341

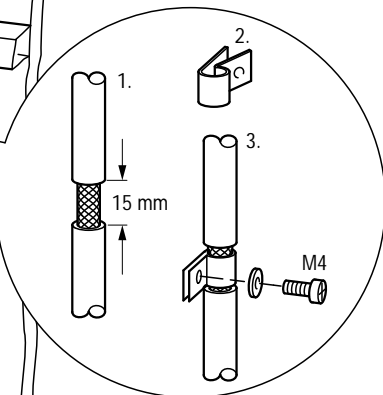

06/97 AWA 823-1572